

Guangdong Province Jieyang Kehe Electronic Industrial CO., LTD



TO-126C Plastic-Encapsulate Transistors

D882 TRANSISTOR (NPN)

FEATURES

Power Dissipation

$P_{CM} : 1.25W (T_a=25^{\circ}C)$

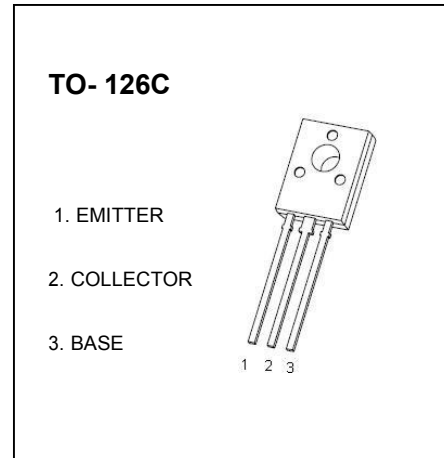

MAXIMUM RATINGS(T_A=25°C unless otherwise noted)

Symbol	Parameter	Value	Unit
V _{CBO}	Collector-Base Voltage	50	V
V _{CEO}	Collector-Emitter Voltage	30	V
V _{EBO}	Emitter-Base Voltage	6	V
I _c	Collector Current -Continuous	3	A
P _c	Total Device Dissipation	1.25	W
T _J	Junction Temperature	150	°C
T _{stg}	Junction and Storage Temperature	-55~+150	°C

ELECTRICAL CHARACTERISTICS(T_a=25°C unless otherwise specified)

Parameter	Symbol	Test conditions	Min	Typ	Max	Unit
Collector-base breakdown voltage	V _{(BR)CBO}	I _C =100μA, I _E =0	40			V
Collector-emitter breakdown voltage	V _{(BR)CEO}	I _C = 10 mA, I _B =0	30			V
Emitter-base breakdown voltage	V _{(BR)EBO}	I _E = 100 mA, I _C =0	6			V
Collector cut-off current	I _{CBO}	V _{CB} =40 V, I _E =0			1	μA
Collector cut-off current	I _{CEO}	V _{CE} =30 V, I _B =0			10	μA
Emitter cut-off current	I _{EBO}	V _{EB} =6V, I _C =0			1	μA
DC current gain	h _{FE(1)}	V _{CE} = 2V, I _C = 1A	60		400	
	h _{FE(2)}	V _{CE} =2V, I _C = 100mA	32			
Collector-emitter saturation voltage	V _{CE(sat)}	I _C =2A, I _B = 0.2A			0.5	V
Base-emitter saturation voltage	V _{BE(sat)}	I _C =2A, I _B = 0.2A			1.5	V
Transition frequency	f _T	V _{CE} =5V, I _C =0.1mA f = 10MHz	50			MHz

CLASSIFICATION OF h_{FE(1)}

Rank	R	O	Y	GR
Range	60-120	100-200	160-320	200-400

TO-126C PACKAGE OUTLINE DIMENSIONS

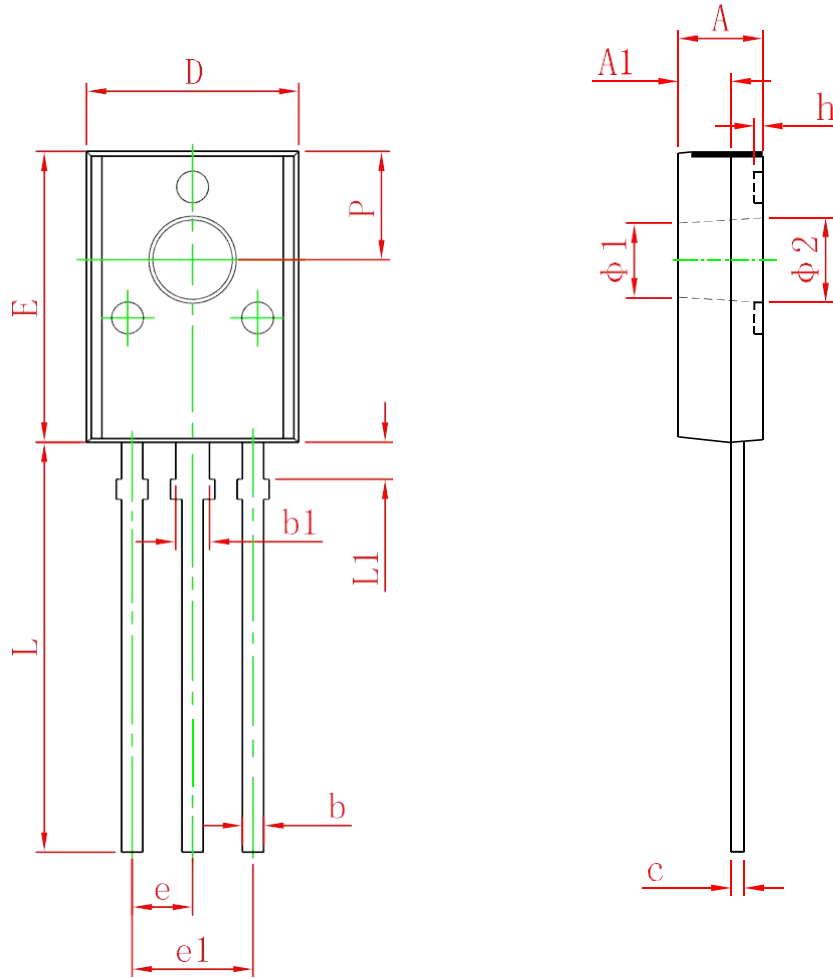

Symbol	Dimensions In Millimeters		Dimensions In Inches	
	Min.	Max.	Min.	Max.
A	3.000	3.400	0.118	0.134
A1	1.800	2.200	0.071	0.087
b	0.660	0.860	0.026	0.034
b1	1.170	1.370	0.046	0.054
c	0.450	0.600	0.018	0.024
D	7.800	8.200	0.307	0.323
E	10.800	11.200	0.425	0.441
e	2.280 TYP.		0.090 TYP.	
e1	4.460	4.660	0.176	0.183
L	15.300	15.700	0.602	0.618
L1	1.300	1.500	0.051	0.059
P	4.040	4.240	0.159	0.167
Φ1	2.700	2.900	0.106	0.114
Φ2	3.100	3.300	0.122	0.130

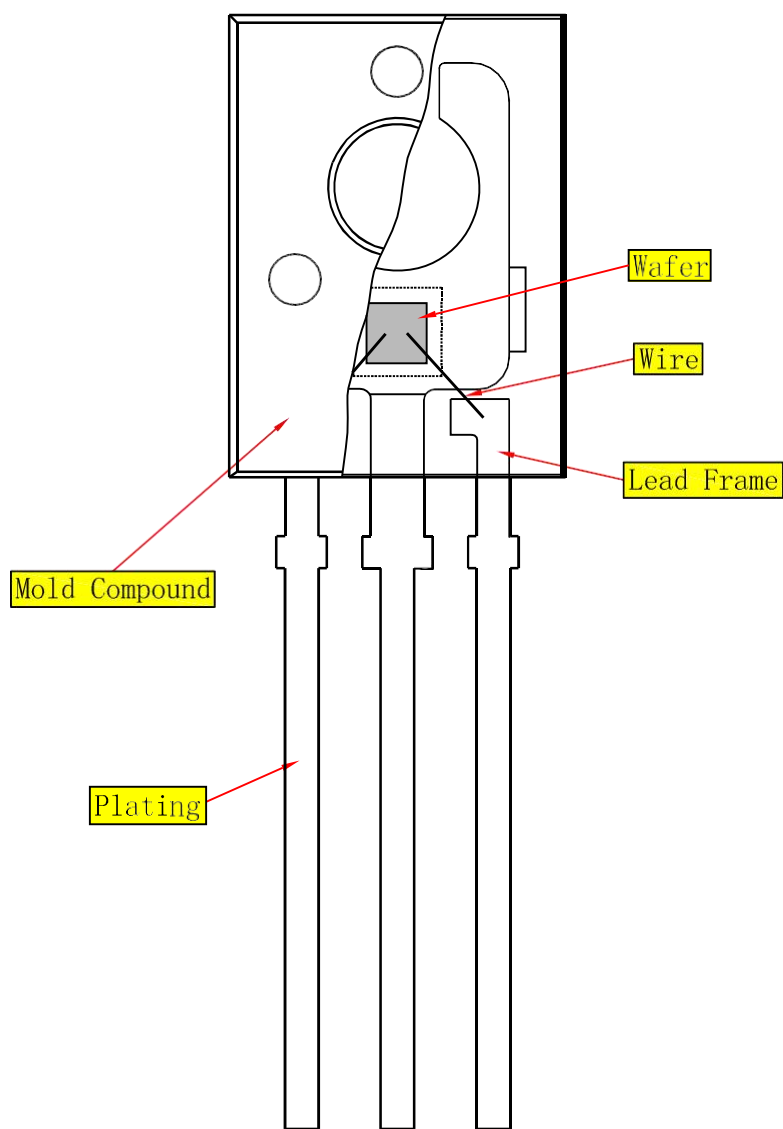

正视图

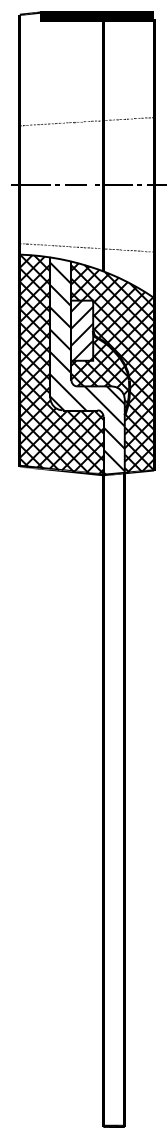

左视图